

# Sutter Solano Medical Center Campus



## About Us

Sutter Solano Medical Center has been serving the residents of Solano County for more than 100 years. The medical center is fully accredited by the Joint Commission on Accreditation of Healthcare Organizations.

As part of Sutter Health, a family of not-for-profit hospitals and physician organizations, Sutter Solano shares resources and expertise to advance health care quality. Providing personalized care in more than 100 communities throughout Northern California, the Sutter Health network is a regional leader in cardiac care, cancer treatment, orthopedics, obstetrics, newborn intensive care and a pioneer in patient safety technology.



## *Sutter Solano Medical Center*

A Sutter Health Affiliate

*With You. For Life.*

300 Hospital Drive  
Vallejo, CA 94589  
707-554-4444

[www.suttersolano.org](http://www.suttersolano.org)

RW 7/06 1.5M

*Finding your way  
around...*



## *Sutter Solano Medical Center*

A Sutter Health Affiliate

*With You. For Life.*



# Sutter Solano Medical Center

Sutter Solano has developed this brochure to assist you in finding your way around our facility. We have listed on the map key areas that you may be looking for.

## Information

If you need assistance, the Information Desk, staffed by our Guild volunteers, is located near the main entrance. If unattended, use the phone on the desk and dial extension 5000 for assistance (707-554-5000).

## Access

The elevators near the main entrance will provide you with access to the lower level and 4th floor only. The north entrance elevators will provide you with access to the lower level, 2nd, 3rd and 4th floors.

## Restrooms

Restrooms are located near the main entrance and near the Imaging Department.

## GROUND LEVEL

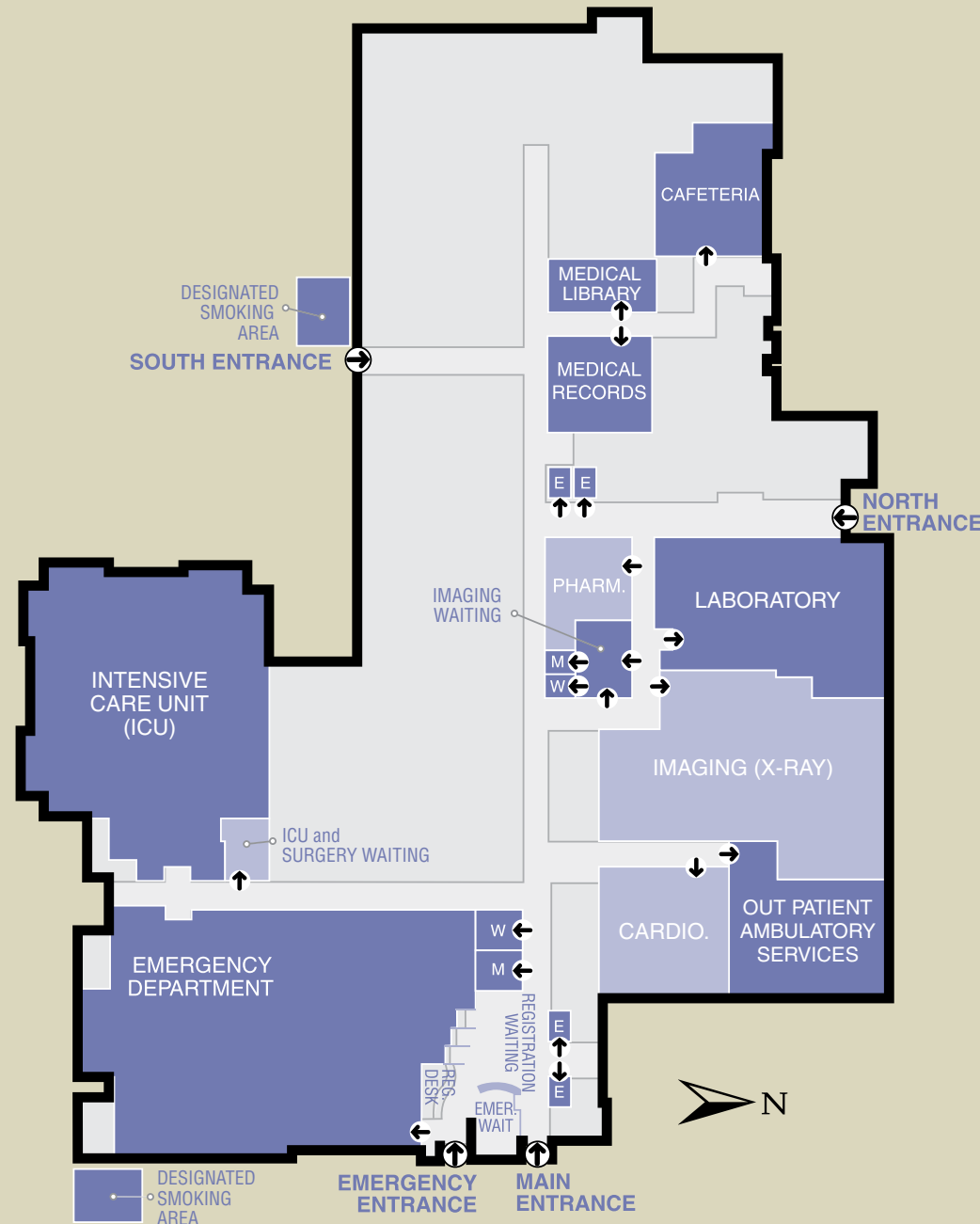

## Designated Smoking Areas

Sutter Solano is a non-smoking facility. Smoking is not allowed inside the facility at any time. Our designated smoking areas are located outside the Emergency Entrance and the South Entrance.

## Cafeteria

Our cafeteria is open Monday through Friday and serves breakfast from 7:30 to 10 a.m., lunch from 11 a.m. to 1:30 p.m. and dinner from 4 to 6:30 p.m. On Saturday and Sunday, the cafeteria serves lunch from 11:30 a.m. to 1:30 p.m.

We also have vending machines in the cafeteria stocked with refreshments and snacks, available 24 hours per day, seven days per week.